



1. 888. 880. 4884

Assembly Instructions For Christmas Tree

YOUR NEW INCLUDES THE FOLLOWING FEATURES

- Super-bright bulbs
- Professionally wrapped light strings
- Easy, fast assembly and disassembly
- Flame-retardant, natural looking tree
- Reusable storage carton

Assembling your tree:

1. Open and secure the positioning of the tree stand by fastening the screws at the base of the stand.
2. Insert the bottom section of the tree into the stand, and secure it by fastening the screws tightly at the top of the stand.
3. Attach the middle section of the tree to the bottom section by inserting the base of the middle section into the top of the bottom section.
4. Attached the top section of the tree (tree top) to the middle section by inserting the base of the top section into the top of middle section.
5. Allow branches to fall into place and gently pull out and down. When adjusting branches, be sure that all wires are free of branch hinges.
6. Locate the extension cords and connect together as indicated in diagram. Plug the long extension cord into the wall. If bulbs do not light, search for loose plug or missing bulbs and replace any defective bulbs.
7. Unplug the lights and shape your tree.

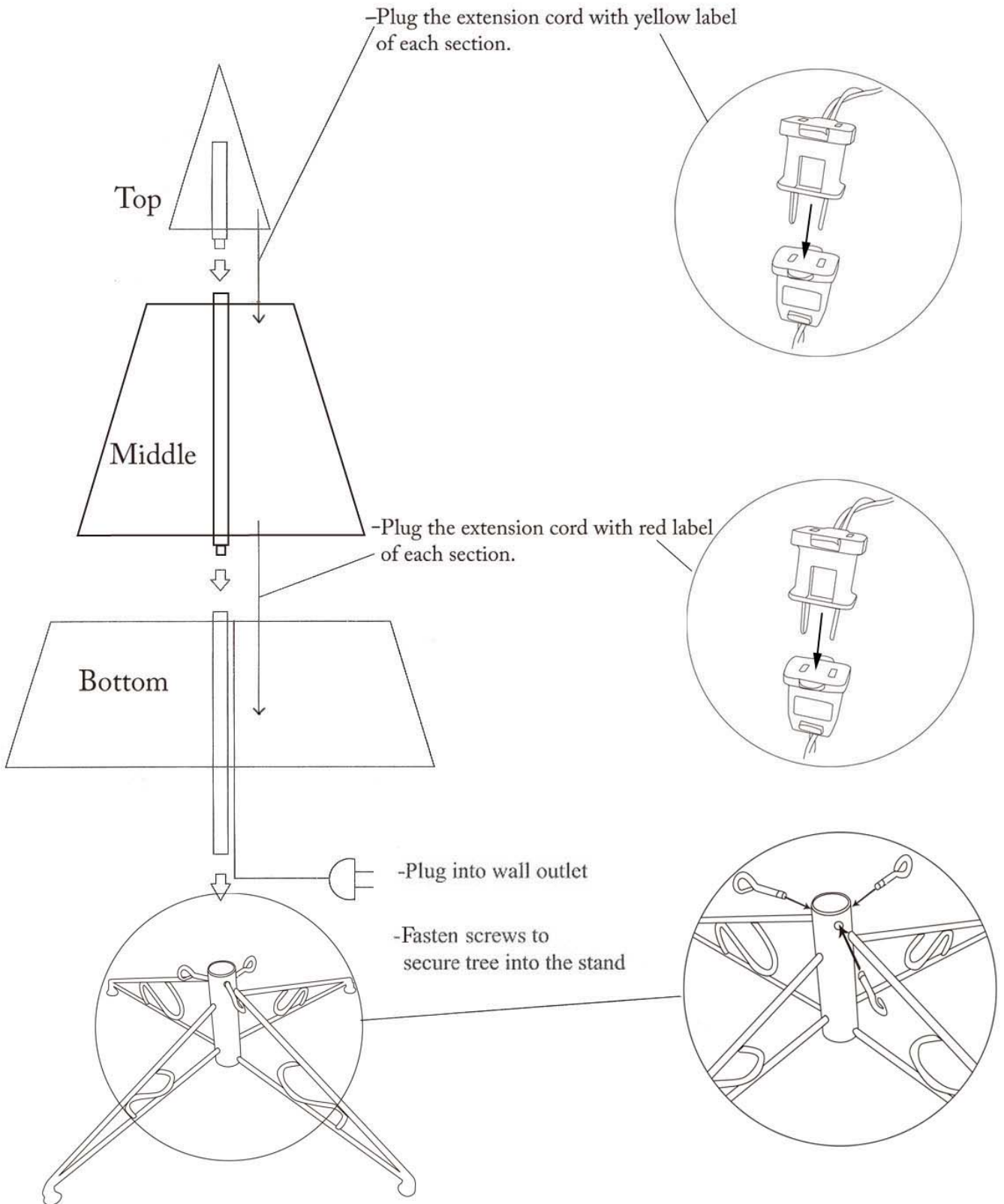

STORAGE:

1. Unplug extension cord from the wall outlet.
2. Unplug each section of extension cord.
3. Gently lift off the top and middle sections, and remove the bottom section from the tree stand.
4. Carefully place the tree in its box and tape it shut. Store box in a cool dry and place the temperature does not exceed 100 °F.

CAUTION:

1. Do not allow metal objects to come in contact with lights or wires.
2. Do not use lights if wire insulation is damaged.
3. Do not overload. Connect only miniature light strings.
4. This pre-lit tree contains 50(or35) lamps per string. To reduce the risk of overheating, replace with 2.5(or 3.5) volts lamp only.
5. Use on 115-125 volts outlet only.

PRELACEMENT:

To replace burned-out bulbs, follow directions below:

1. Make sure the set is unplugged.
2. Pull bulbs and base straight out of socket.
3. Inset replacement bulbs and base into empty socket, making sure base is connected.
4. Plug light set back in wall outlet.

Important: If the light set does not light, push each bulb firmly into the socket. Bulbs may have loosened during transportation.

CATUION:

- BURNED OUT BULBS SHOULD BE REPLACED QUICKLY. SEVERAL BURNED OUT BULB LEFT MAY CAUSE OTHERS TO BURN OUT.
- TO REDUCE THE CHANCE OF EXCESSIVE HEAT AND DAMAGE DO NOT ATTACH DECORATIVE FEATURES TO BULBS.
- TO REDUCE THE RISK OF FIRE AND ELECTRICAL SHOCK. DO NOT PLACE TREE NEAR OPEN FLAMES.
- KEEP LIGHT OUT OF THE REACH OF YOUNG CHILDREN.
- TURN SET OFF WHEN LEAVING HOME OR RETIRING AT NIGHT.
- DO NOT OVERLOAD. CONNECT ONLY MINIATURE LIGHT.
- FOR INDOOR OUR OUTDOOR USE 115-125 VOLTS A.C.
- DO NOT CONNECT MORE THAN 3 SETS.DO NOT CONNECT WITH STANDARD C-7 OR C-9 LIGHT SETS OR STRINGS.A SHORT CIRCUIT AND/OR FIRE MAY RESULT.

CAUTION:

“This powerunit is intended to be correctly orientated in a vertical or floor mount position.”

“CAUTION: To reduce the risk of fire and electric shock:
Do not install on trees having needles, leaves or branch coverings of metal or materials which look like metal, and
Do not mount or support strings in a manner they can cut or damage wire insulation.”

CAUTION:

“CAUTION- To reduce the risk of overheating, replace burned-out lamps promptly.
Use 2.5 volt, 0.25 watt lamps only.”

(The blanks shall be filled in with the voltage and wattage of the replacement lamps)

CAUTION:

C) “Replace lamp with only 2.5 Volt, 0.25 Watt regular brightness type lamp (provided with product).”

The blanks shall be filled in with the voltage and wattage of the lamp and type of lamp, such as super bright, regular brightness, energy saving, or LED. Words located in parentheses are applicable only if the replacement lamp is provided with the product.

Typically, super-bright lamps are rated above 0.42 Watts, regular brightness lamps are rated between 0.32-0.40 Watts; and energy saving lamps are rated approximately 0.25 Watts.

CAUTION:

“CAUTION” and the following: “This lighting string is rated 210 Watts (1.75 Amps), do not overload.

Connect other lighting strings or decorative outfits end-to-end up to a maximum of 210 Watts (1.75 Amps) total.”